



Northern Town of La Ronge
Box 5680 1212 Hildebrand Drive
La Ronge, Saskatchewan S0J 1L0

REQUEST FOR PROPOSALS

TOWN OF LA RONGE

Patterson Park Performance Area



Project Statement

Project Name: Patterson Park Performance Area
Project Location: Parcel B Plan CN1121 and Parcel BB Plan 101816399, Patterson Park, La Ronge, Saskatchewan.
Project Contact: Mike Maggrah
Contact Phone: 306-420-8725
Contact Email: infrastructure@laronge.ca
Proposal due date: 3:00pm, Friday November 29, 2019

Purpose

Design and construction of a performance area for musical, theatre and local events in Patterson Park.



Submission Details

- 1 Submissions may be made email, letter mail and in person **by Friday November 29, 2019 at 3:00pm** to:

Town of La Ronge
c/o Mike Maggrah, Projects Manager
Box 5680
1212 Hildebrand Drive
La Ronge, SK. S0J 1L0
infrastructure@laronge.ca

- 2 All hard copy submissions should be delivered marked "Town of La Ronge Patterson Park Performance Area Proposal", and all email submissions delivered as an attachment with the subject line, "Town of La Ronge Patterson Park Performance Area Proposal".
- 3 If a submission is received after the deadline, the Town reserves the right to return those submissions to sender, unopened.
- 4 All costs associated with preparation of a submission, including costs incurred after the submission deadline will be borne by the proponent.
- 5 The Town is not responsible for any costs, losses, or liabilities incurred as a result of submitting a proposal, nor due to their acceptance or non-acceptance of a proposal.

Project Background and Objectives

The Town of La Ronge as part of a revitalization of Patterson Park and capital improvement budget allocations will be contracting the development of a performance area in Patterson Park.



Goals of this project are:

- Provide a space for organized and unorganized performance arts in the park;
- Activate underutilized park space, creating an attraction for positive social behaviours;

Patterson Park is located on Parcel BB Plan 101816399 and Parcel B Plan CN1121 southeast of La Ronge Avenue (approximate performance area location: 55.102921, -105.282876).



Description of the Work

Construct a visually appealing and complementary structure to highlight the natural beauty of the park and lakefront setting.

The Work includes but is not limited to the following:

General:

- a) Mobilization, demobilization, site safety, administration, site clean-up, warranties, general requirements, barriers, temporary works, protection, signage, traffic control, coordination, etc.;
- b) Acquisition of permits and licenses required to complete the work;
- c) Coordination where necessary with the Town Project Manager;
- d) All labour, equipment, tools and transport required to complete work is to be provided by the Contractor;
- e) Any damage that may occur is to be repaired by the Contractor to match the pre-existing condition; and
- f) Contractor is responsible for all disposal/landfill fees;
- g) Contractor is responsible for any preliminary site visits required to determine site conditions. Should the contractor wish to investigate land suitability the Town should be contacted in advance for permission for any ground disturbance.

Design:

- a) Offers some protection from weather and sun for performers;
- b) Provides a minimum 24 feet wide by 16 feet deep space/footprint for performers and equipment;
 - (i) If footing or base material is proposed to be a concrete pad or similar, it is expected the contractor inspect the site and include in the proposal how the structure would be tied into the existing concrete base at that location.
- c) Honours local context using materials that mimic the natural setting or design that is inspired by the park, the Town and local history;
- d) Be engineered to withstand typical snow load and local weather;
- e) Have as part of the design, or be able to integrate lighting and power to be installed permanently;
 - (i) Power service will be provided within close proximity to the site.
- f) Use materials/design/construction methods that are resistant to vandalism;
- g) May include design for removable panels or structural components that enclose one or more sides to project sound or provide increased protection from the weather. When not in use, the performance area is to be an open



back, with the option of additional wall panels that can be folded up or removed/installed for events.

- (i) Any removable components must be easily transported to storage facility with typical municipal vehicles.

Warranty

- a) Minimum 10 year warranty on materials.

Appended Documents Included:

Appendix A - Patterson Park Performance Area Concept: Conceptual design and location for the performance area in Patterson Park.

Timetable/Schedule

Installation will be completed, and fully functional by June 19, 2020.

Initial design and layout will be delivered with the proposal package, and all final drawings and specifications shall be submitted for approval to the Project Manager within 2 weeks of the contract being awarded.

Project Commencement Date: Spring 2020.

Project Completion Date: June 19, 2020.

Costing

Fixed Price

Evaluation of Proposals

All proposals will be evaluated for their compliance and suitability with respect to the requirements of the Town. The Town may conduct any inquiries, clarifications or investigations on any of all the proposals without having any duty or obligation to do so for all.

The lowest price will not necessarily be accepted. Proposals will be evaluated on the basis of best overall value to the Town in consideration of: ability to meet timeline, product quality and aesthetic, company experience and reputation, service and price.



APPENDIX A – PATTERSON PARK PERFORMANCE AREA CONCEPT

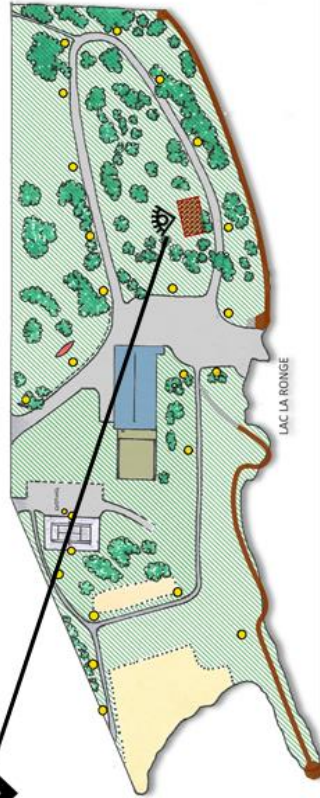

PATTERSON PARK
Performance Area Concept

Top: Photo of Patterson Park at performance area site.
Bottom Left: Modified photo to show location and orientation of performance area concept.



Bandstand/Performance Area

- ♀ View of Lac La Ronge
- ♀ Oriented toward street
- ♀ In treed area for sound buffering, shade and wind protection
- ♀ Open to encourage temporary and day use only
- ♀ Simple design to allow for flexibility in use
- ♀ Natural materials used for construction
- ♀ Power and lighting available for nighttime use



PATTERSON PARK Performance Area Concept